

# MC-121 Pastry Kitchen

This kitchen is equipped with a PC, Audio/ Visual system and wall mounted **interactive display**. Microphones and a ceiling mounted video camera are available for recordings and virtual meetings as well. A lavalier and handheld microphone for voice enhancement are also available for use. The following instructions will allow you to operate and also connect any additional devices to the wall display.

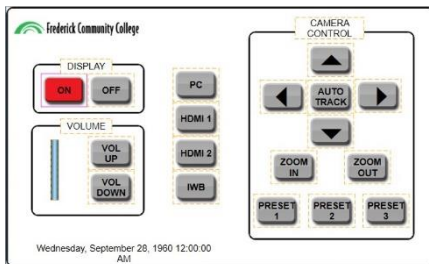

The controls to turn the display **ON** and **OFF**, **control the volume** and select your **video sources** are located on the wall to the left of the display. The PC is located **behind** the wall display on the left side of the screen. If an image of the PC start up screen is not visible on the display after selecting PC on the touch panel, check to see that the PC is powered up and indicator light is on. A wireless keyboard and mouse have also been provided.

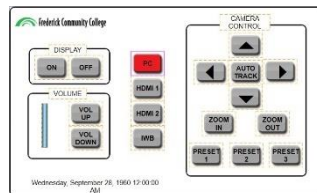

After turning on the display, select the input source to the display by pressing the corresponding button on the control touch panel.

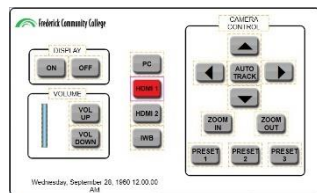

There are two additional HDMI ports to connect a laptop or other personal device to the display located on the wall just below the wall control touchpanel. After connections are made, touch the corresponding button **HDMI 1** or **HDMI 2** on the touch panel to show image on the display.

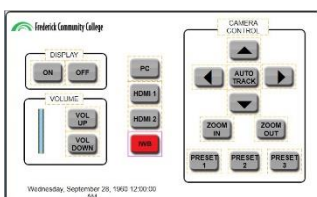

To use the interactive display features, select “IWB” on the control touch panel. You can now use the touch screen as an interactive white board.



Touching the small up arrow on the display will produce a toolbar from which you can select various tools or other interactive options the Samsung Flip offers. See reverse side for detailed instructions.

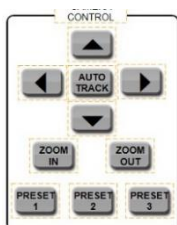

Controls to position the camera, zoom in or out and select preset workstations locations are to the right of the display functions on the control touchpanel.

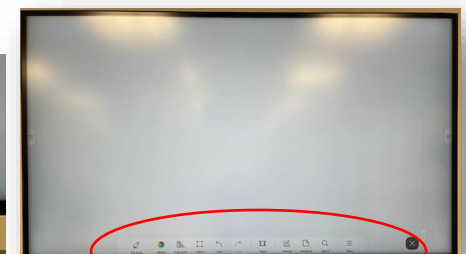

The interactive display can be adjusted up or down for user preference. Slide it up or down to desired height.

## Pen Mode

### Screen elements



1		Tap to open the <b>IMPORT/EXPORT</b> window.
2	Pen Mode	<ul style="list-style-type: none"> <li><b>IMPORT:</b> View the screen of a mobile device or PC connected to the product, or import data such as images from a connected USB or network drive.</li> <li><b>EXPORT:</b> Share your creations in various ways.</li> </ul>
3	Palette	Tap to open the Palette. You can select the colour and thickness of the pen and the highlighter.
4	Maths Tools	Use math tools to make geometric constructions and take measurements.
5	Select	Select the area you want to edit, capture, send in an email, print, or search.
6	Undo Redo	Undo or redo the last action. <ul style="list-style-type: none"> <li>If any page editing actions such as page adding, deleting, and moving are found, "Undo" is reset.</li> </ul> <p>↶↷ can be performed up to 20 times for each individual.</p>
7	Pages	You can add or delete a page, and you can also navigate through pages on the current roll.
8	Note On/Off	Create a layer to write or draw on over the screen which can also be saved the captured image.
9	Miniboard	Bring out Miniboard to take notes or draw as a separate layer above the viewer or source screen.
10	Search	Tap to search the internet.
11	Menu	Tap to see more options available in the menu.
12	✕	Close the current roll and create a new roll.
13	Page breaking line	See page lines.
14	⬅️➡️	Scroll through pages.
15	Bezel Scroll	Scroll the black area to move the pages.

## Menu



Buttons	Description
<b>NEW</b>	Create a new roll.
<b>SAVE</b>	Save the current roll.
<b>ROLL BROWSER</b>	Open, delete or export saved rolls.
<b>FORMS</b>	Change the background format. ✎ This menu is only visible in <b>PEN MODE</b> .
<b>ROLL LOCK / UNLOCK</b>	<ul style="list-style-type: none"> <li><b>ROLL LOCK:</b> Press a six-digit password to lock the current roll.</li> <li><b>UNLOCK:</b> To unlock a locked roll, press the six-digit password you set when locking the roll.</li> </ul> <p>✎ Once unlocked, the current roll remains unlocked until it is locked again.</p>
<b>SETTINGS</b>	You can see the configuration menu.
<b>HOW TO USE</b>	You can see How To Use.

## Menu

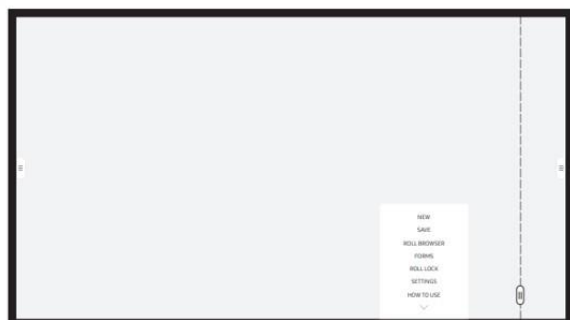
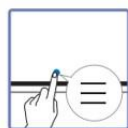

Buttons	Description
<b>NEW</b>	Create a new roll.
<b>SAVE</b>	Save the current roll.
<b>ROLL BROWSER</b>	Open, delete or export saved rolls.
<b>FORMS</b>	Change the background format. ✎ This menu is only visible in <b>PEN MODE</b> .
<b>ROLL LOCK / UNLOCK</b>	<ul style="list-style-type: none"> <li><b>ROLL LOCK:</b> Press a six-digit password to lock the current roll.</li> <li><b>UNLOCK:</b> To unlock a locked roll, press the six-digit password you set when locking the roll.</li> </ul> <p>✎ Once unlocked, the current roll remains unlocked until it is locked again.</p>
<b>SETTINGS</b>	You can see the configuration menu.
<b>HOW TO USE</b>	You can see How To Use.