

**L-152 meeting room is equipped with a computer, flat panel LED wall display  
Web camera and an Audio/ Video system controller.**

If after turning the display **ON** and the **PC** button is **red**, you may need to log into the PC before a **Windows Image** will appear on the display.  
If not, check to see if the PC is powered on.

- The **PC power button** is located on the front of the computer.
- Log in by typing your network name and password.
- **REMEMBER TO LOG OUT WHEN YOU ARE FINISHED.**



The controls for the wall display **power, volume, and input sources** are located on the wall to the left of the display. Additional **USB ports** can be found on the left side of the PC.

An **HDMI cable** with additional dongles to fit most laptops can be found on the table as well.



Video conferencing can be done by using a laptop with built-in camera and microphone or attaching an external camera/microphone to one of the **USB** computer ports.

**Separate instructions to connect wirelessly to the display using ScreenBeam technology can be found on the back of this instruction sheet.**

**For immediate technical assistance, please call the I.T. Service desk at X2509 from your classroom or hallway phone or by calling 301.846.2509.**

**Security can be reached by calling x2453 or 301.846.2453**

# Wireless Video Display

- Compatible Windows laptops (and Android devices) can display their video and content wirelessly using a device connected to the display known as **ScreenBeam**.
- If you are unsure of whether you have a compatible Windows laptop, press the Windows Key and P to see if the projection menu appears.
- **It is not compatible with any Apple devices.**
- It will create a point-to-point connection between your device and the wall display.

Power on the display by pressing the **ON** button on the wall controller mounted next to the podium.

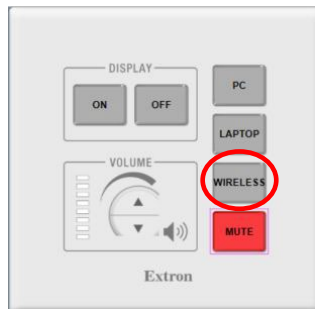

Select : **Wireless** on the wall controller

A splash screen showing **ScreenBeam** will appear.

On your laptop, press the **Windows Key** and “**P**” to bring up : **Projection Options**

Select : **Connect to a wireless display**

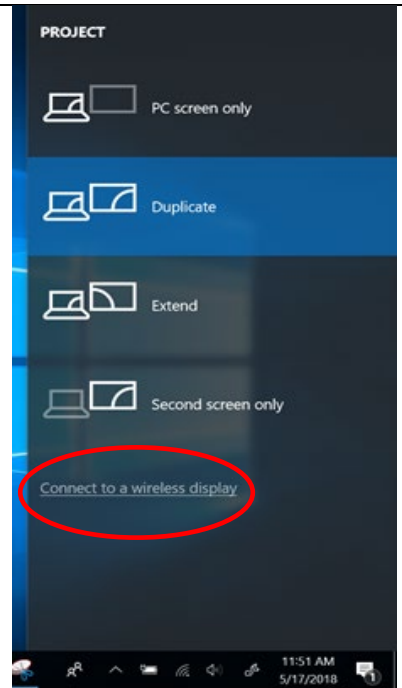

Alternately, you can type “**Project**” in your search box.

Then select: **Project to a second screen.**

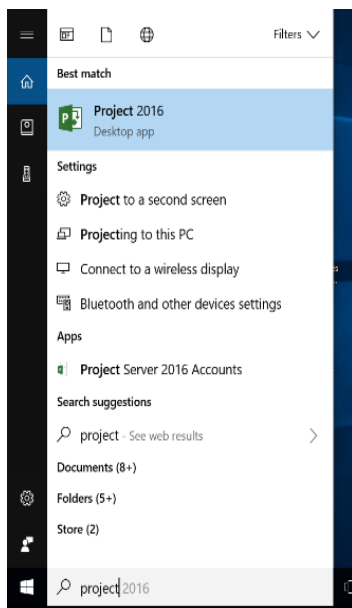

Select : **L128-SB Display** from the connect list shown.

The **ScreenBeam** will display a code on the wall display. Enter the code in the box on your laptop and your image will appear on the display.

