

## Welcome to G-107.

You can connect your laptop or other devices to the wall mounted display using an HDMI cable or project wirelessly using ScreenBeam.

- \* The **POWER** and **INPUT** selection controls can be located to the right of the wall display.
- \* The HDMI cable connection is located just below the table on the right. Select **HDMI 1** when using a cable connected to the wall input.
- \* For **Wireless connection** to the display - see instructions on the reverse side.

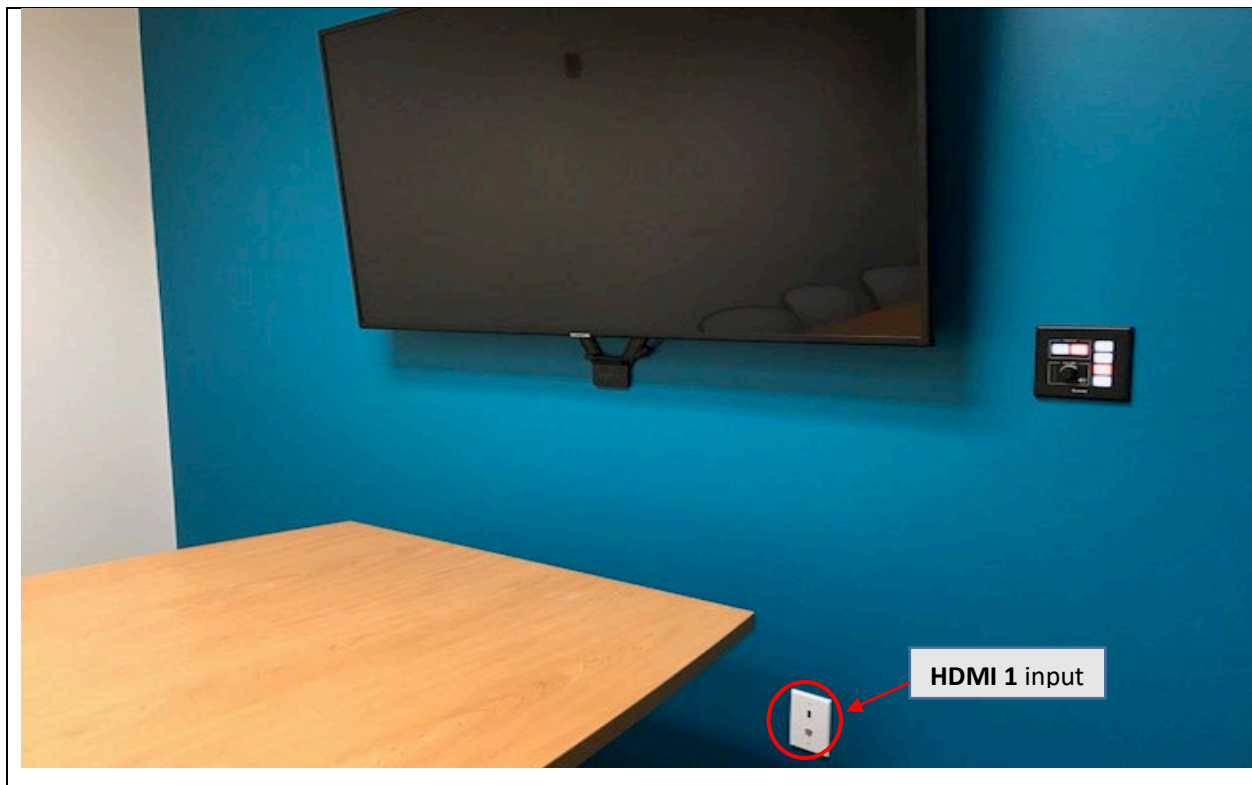

For immediate technical assistance, please call the **I.T. Service desk at X2509** from a classroom or hallway campus phone or by calling **301.846.2509**.

For any non-urgent issues or requests, please submit a ticket to the **IT Helpdesk**.

# Wireless Video Display

- Compatible Windows laptops (and Android devices) can display their video wirelessly using a device connected to the projector known as **ScreenBeam**.
- If you are unsure of whether you have a compatible Windows laptop, press the Windows Key and P to see if the projection menu appears.
- It is not compatible with any Apple devices.**

Power on the display by pressing the **ON** button on the wall controller mounted to the right of the display.

Select : **Wireless Video**

A splash screen showing **ScreenBeam** will appear.

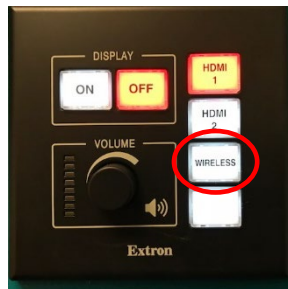

On your laptop, press the **Windows Key** and “**P**” to bring up : **Projection Options**

Select : **Connect to a wireless display**

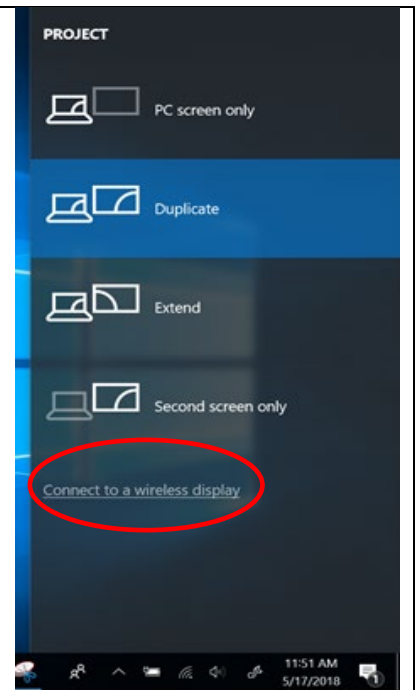

Alternately, you can type “**Project**” in your search box.

Then select: **Project to a second screen.**

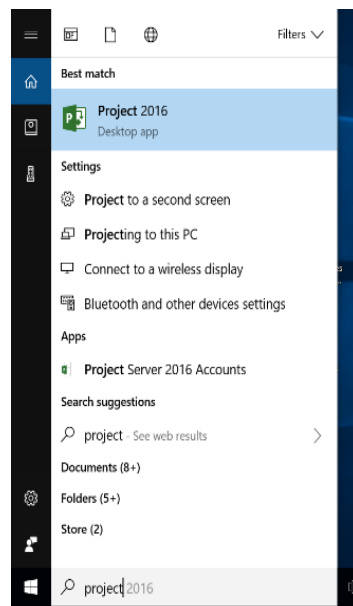

Select : **G107 Conference Rm-SB**  
From the connect list shown.

The **ScreenBeam** will display a code on the projector screen.

**Enter code** in the box on your laptop and your image will appear.

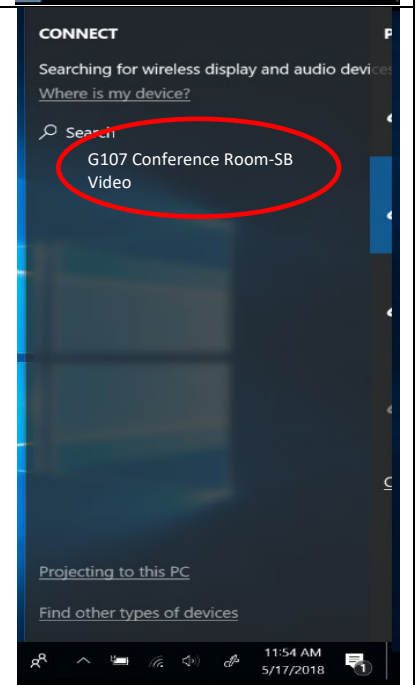

- It will create a point-to-point connection between your device and the room display.